



Existing Landscaping Scheme		
Sketch	Type	Qty
	Citrus trees	3
	Almond trees	3

Proposed Landscaping scheme		
Sketch	Type	Qty
	Olive tree	9

Construction of rubble wall shall be done manually and traditional methods shall be applied. The rubble walls shall be built using rough-dressed dry stone standing by friction without any use of mortar or concrete.

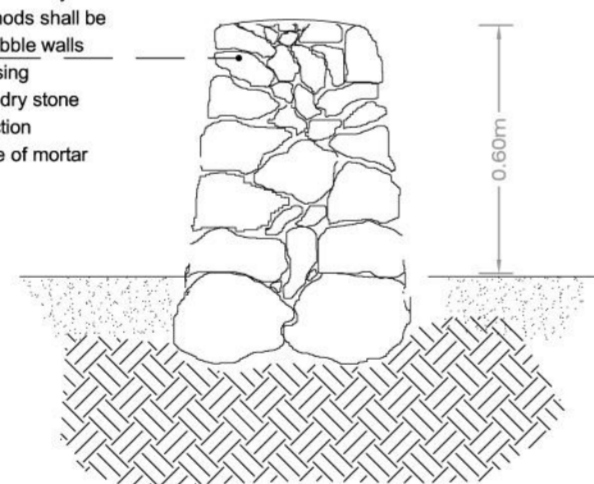

Proposed Rubble Wall
scale 1: 20

NOTES:

- ALL DIMENSIONS ARE IN METERS
- APPROVED FLOORAREA: 150 SQUARE METERS
- PROPOSED FLOOR AREA 200 SQUARE METERS
- PROPOSED SWIMMING POOL: 50 SQUARE METERS
- PROPOSED DOMESTIC STORE: 50 SQUARE METERS

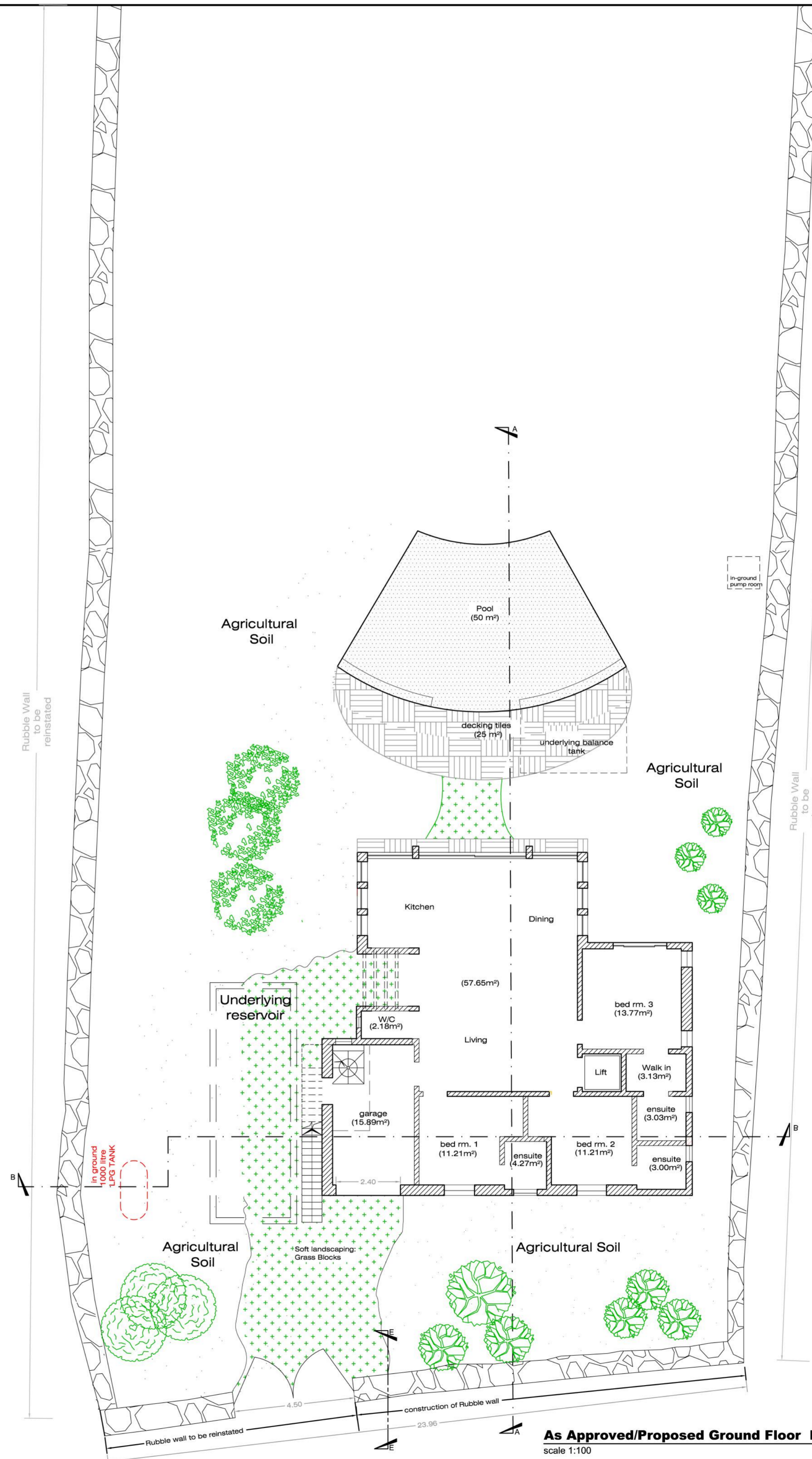
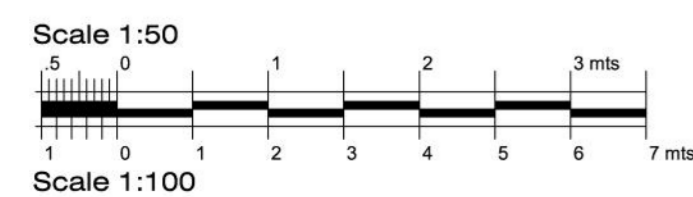

As Approved/Proposed Ground Floor Plan
scale 1:100