

- Ownership 1 : 275.63 m²
- Ownership 2 : 273.00 m²
- Ownership 3 : 273.00 m²
- Common Areas : 271.82 m²
- Office Spaces : 1261.54 m²

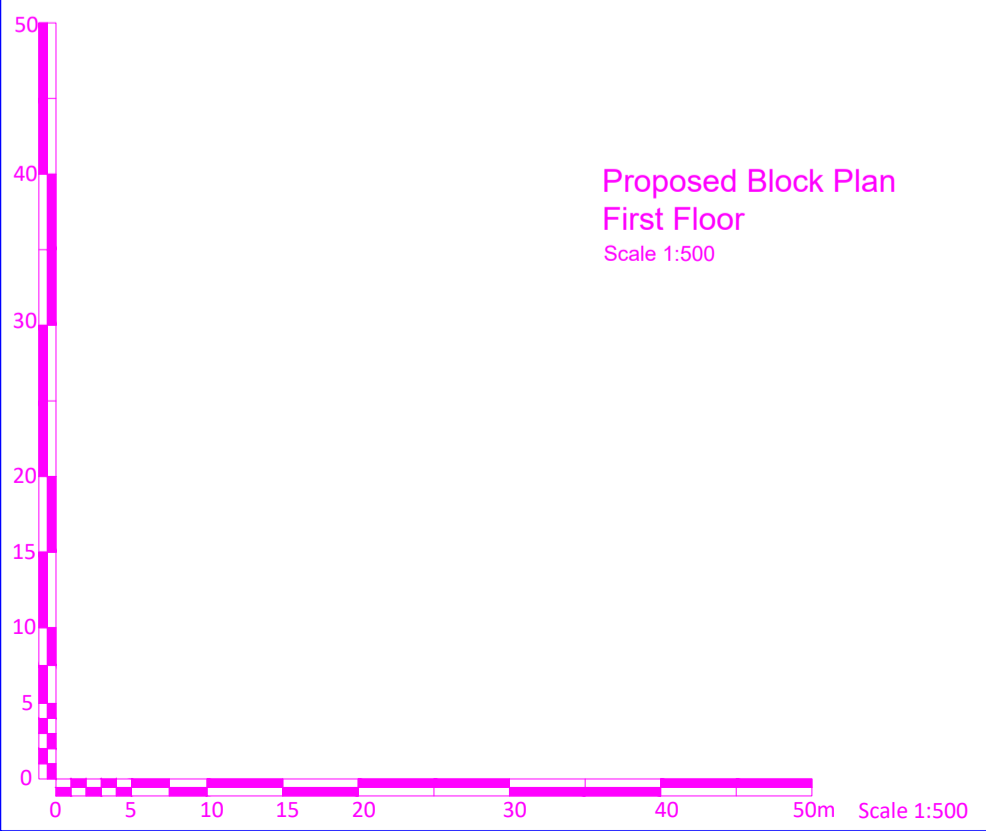

Proposed Block Plan
First Floor
Scale 1:500



Rev:	Date:	Description:
Architect & Civil Engineer:		
PERIT WILLIAM LEWIS B.E.&A. (Hons.), M.Sc. Road Eng., A.&C.E.		
83, Triq il-Għida, Gormi, QRM2122 Tel. / Fax: 21444845, Mobile: 79444845 Email: william@peritwilliamlewis.com		
Client: Charles Cremona		
Works: Metalco Ltd., 48, Sqaq il-Fdal tal-Hadid, Triq Valletta, Luqa		
Dwg Title: Proposed Block Plan - First Floor		
Scale:	Date:	
1:500 (A1)	14.04.2021	
MEPA Ref:	Drawn By:	
PA/00000/00	FG	
Job No:	Drawing No:	Rev:
CRC002-005	02/B	01