

Existing Block Plan  
Ground Floor  
Scale 1:500

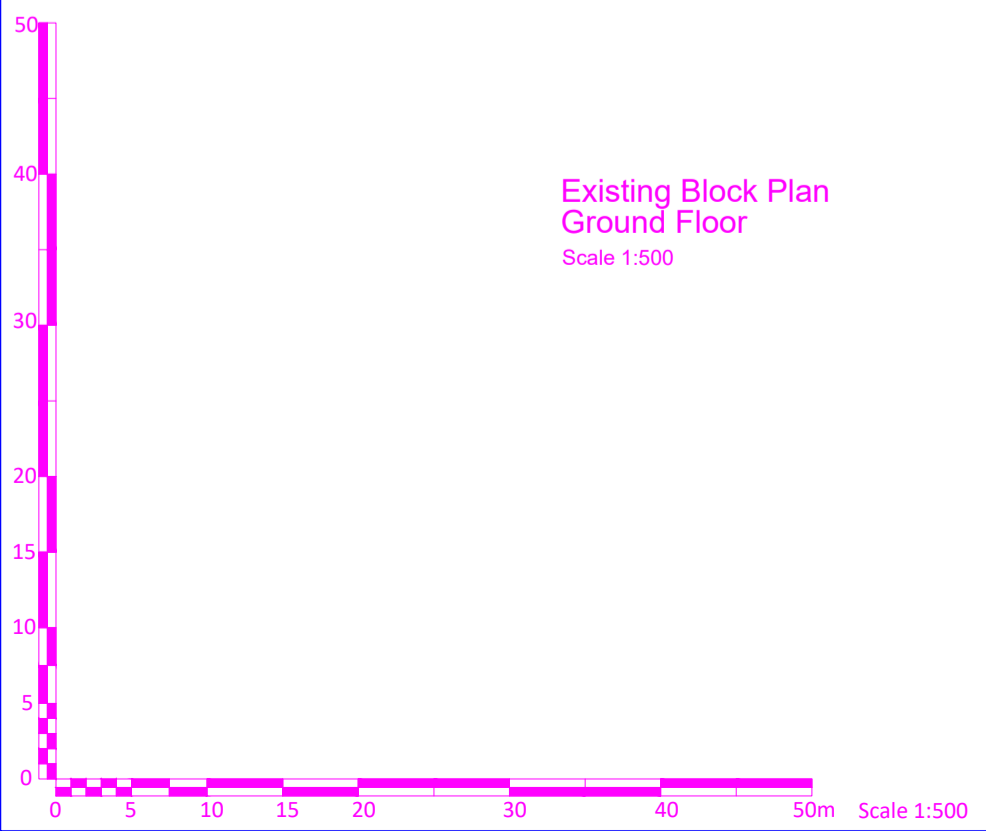

Rev:	Date:	Description:
<p align="right"><b>Architect &amp; Civil Engineer:</b></p> <p align="right"><b>PERIT WILLIAM LEWIS</b> B.E.&amp;A. (Hons.), M.Sc. Road Eng., A.&amp;C.E.</p> <p align="right">83, Triq il-Gdida, Gormi, QRM2122 Tel. / Fax: 21444845, Mobile: 79444845 Email: william@peritwilliamlewis.com</p>		
<p><b>Client:</b> Charles Cremona</p>		
<p><b>Works:</b> Metalco Ltd., 48, Sqaq il-Fdal tal-Hadid, Triq Valletta, Luqa</p>		
<p><b>Dwg Title:</b> Existing Block Plan - Ground Floor</p>		
<b>Scale:</b>	<b>Date:</b>	
1:500 (A1)	14.04.2021	
<b>MEPA Ref:</b>	<b>Drawn By:</b>	
PA/00000/00	FG	
<b>Job No:</b>	<b>Drawing No:</b>	<b>Rev:</b>
CRC002-005	01/A	00